

RICOH

RDC-i700 **IMAGE CAPTURING DEVICE**

Camera Operation Manual

To ensure correct use of your camera, read this manual carefully before use. Keep the manual handy for future use.



Introduction

Thank you for purchasing a Ricoh RDC-i700. This manual explains the correct handling procedures and precautions for your camera. To ensure the best performance, please read the manual thoroughly before using the camera. Keep the manual handy for quick future reference.

Ricoh Co., Ltd.

Test Shots

Check that your camera is recording the images correctly by taking a number of test shots.

Copyright

Reproduction or alteration of copyrighted documents, magazines, music and other materials, other than for personal, home or similarly limited purposes, without the consent of the copyright holder is prohibited.

Exemption from Liability

Ricoh Co., Ltd. assumes no liability for failure to record or play back images caused by malfunction of the RDC-i700.

Warranty

This product is manufactured to local specifications and the warranty is valid within the country of purchase. Should the product fail or malfunction while you are abroad, the manufacturer assumes no responsibility for servicing the product locally or bearing the expenditure incurred therefor.

Radio Interference

Operating the RDC-i700 in the vicinity of other electronic equipment may adversely affect the performance of both devices. In particular, operating the camera close to a radio or television may lead to interference. If interference occurs, follow the procedures below.

- Move the camera as far away as possible from the TV, radio or other device
- Reorient the TV or radio antenna.
- Plug the devices into separate electrical outlets.

- This publication may not be reproduced in whole or part without the express written permission of Ricoh. ©2000 Ricoh Co., Ltd. All rights reserved.
- Ricoh reserves the right to change the contents of this publication without notice. Considerable care was taken in preparing this manual. If, however, you have questions about any part of the manual, or note mistakes or inaccuracies, please contact us at the address listed on the back cover.

Microsoft, MS and Windows are registered trademarks of Microsoft Corporation in the United States of America and other countries.

Macintosh is a registered trademark of Apple Computer, Inc., in the United States of America and other countries.

CompactFlash™ is a registered trademark of SunDisk Corporation in the United States of America.

SmartMedia™ is a trademark of Toshiba Corporation.

All trademarked company and product names mentioned in this manual are the property of their respective owners.

How to Use the Operation Manuals

Five operation manuals are supplied with this camera.

Use each operation manual as shown below to suit the purpose.

Open the package



Read This Before Proceeding!

These instructions explain the procedure for checking the contents of the package and loading the battery to enable you to use the camera straightaway.

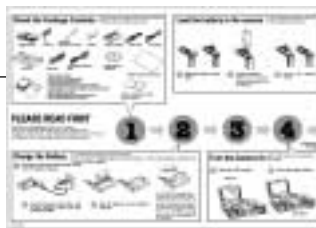

Basic operation

Camera Operation Manual (this manual)

This manual explains in detail the preparations to take before using the camera together with the procedures for shooting and playback using the various functions.



Using the communication and Internet functions

Communication/Internet Operation Manual

This manual explains the procedures for transmitting images and using Internet functions.



Sending and receiving data using the camera and a PC

Connecting to a Personal Computer Operation Manual

This manual explains the procedures for connecting the camera to a PC, transmitting images from the camera to the PC and operating the camera from the PC.



A useful guide for carrying around with you

Simple Operation Guide

This guide contains a simple explanation of the most frequently used procedures, including shooting, playback and transmitting.



CONTENTS

How to Use the Operation Manuals	1
Parts & Names	6
Safety Precautions	8

Chapter 1 Getting Started

Before Using the Camera	14
Attaching the Neck Strap	14
Attaching the Lens Cap	14
Powering the Camera	15
Charging the Battery	15
Loading the Battery	16
Connecting an AC Adapter	18
Storage Memory	19
Inserting a CF Card or PC Card	20

Chapter 2 Basic Operations

Turning On/Off the Camera	24
How to Use the Mode Dial	25
LCD Monitor and LCD Panel	26
Recording Mode	26
Play Mode	27
Adjusting the LCD Monitor	28
Adjusting the LCD Monitor Contrast	28
Using the Stylus Pen	28
Fine Adjustment of the LCD Monitor and Touch Screen	29
How to Select the Items	31
Using the Stylus Pen	31
Selecting and Canceling Items	32
Character Input and Writing/Drawing	35
Using the On-screen Keypad	35
Using the Tool Palette	37
Registering the Camera Information	39
Setting the Date and Time	39
Registering Owner Information	42

At the end of this manual troubleshooting for error messages, alphabetical index and index by functions are listed for your convenience.

Before You Start Recording	43
Formatting the Storage Memory	43
Adjusting the Viewfinder Diopter	44
How to Hold the Camera	44

Chapter 3 Shooting

Basic Shooting	48
Operation Flow	48
Selecting a Recording Mode	49
Selecting the Storage Memory	50
Selecting a Folder	51
Selecting an Image Quality Mode	52
Checking the Position of the Subject	53
Setting the Size of the Subject (Zoom)	54
Shooting (Still Picture Mode)	55
Special Shooting Functions	58
Recording Text (Text Mode)	58
Recording Voice Memo (Voice Memo Mode)	59
Continuous Shooting (Continuous Shooting Mode)	59
Shooting Motion Pictures (Motion Picture Mode)	60
Shooting Still Pictures and Text with Voice Memo	61
Changing Flash Modes	62
Setting the Exposure Compensation	64
Changing the White Balance Mode	66
Using the Self-Timer	67
Close-up Shooting (Macro Mode)	69
Manual Focus Shooting	70
Date Imprinting	71
Changing the ISO Sensitivity	72
Using Auto Bracket	73
Redeye Reduction Mode	74
Non-Compressed Mode	75
Monochrome Mode	76
Interval (Time-lapse) Recording	77
Soft Mode	78
Time Exposure Mode	79
Signature Imprint Mode	80
Changing the Brightness in Text Mode	81

Chapter 4 Playback/Deleting

Basic Playback	84
Files Playable on the Camera	84
Playing a Still Picture, Text or Continuous Shooting File	84
Playing a Voice Memo File	85
Playing a Motion Picture File	86
Playback Using a TV	88
Special Functions	89
Switching to Edit Mode	89
Displaying One File at a Time (Single Image Playback)	89
Displaying Several Files at Once (Thumbnail Playback)	90
Magnifying a File (Zoom Playback)	91
Copying and Moving Files	92
Editing Images	94
Adding a Memo or Voice Memo to a File	97
Selecting a Folder	100
Protecting a File	100
Auto Playback	101
Setting DPOF (Digital Print Order Format)	103
Preparing and Playing a Presentation	106
Preparing a New Presentation	106
Playing a Presentation	108
Deleting a Presentation	111
Deleting a File	112
Deleting a Selected File	112
Deleting All Files	113

Chapter 5 Camera Settings and Other Functions

Changing Camera Settings	116
Keep Settings	116
Beep Sound Setting	117
Auto Power Off Setting	117
Changing the Display Language	119
Changing the Video-out Signal Method (NTSC/PAL)	119
Changing the LCD Confirmation Time	120
Adding or Deleting a Folder	121
Turning the Camera On/Off When the LCD Monitor is Opened	122
Initializing the Settings	123
Using the Remote Control	125
Shooting	125
Playback	126
Deleting	127

Appendix

Troubleshooting	130
Error Messages	133
Using This Camera Abroad	135
Recording Capacities	136
Accessories	137
Handling Precautions	138
Care and Storage	139
Specifications	140
About the Warranty and Servicing	142
Index	144



Tips to Extend the Recording and Playback Times	17
SmartMedia Memory Cards	22
Auto Power Off	26
How to Verify the Date and Time	41
LCD Monitor Display (Camera Mode)	49
Focus Lock Shooting	57
Remote Control	68
Shutter Release Button	69
LCD Monitor Display (Play Mode)	87

Parts & Names

■ Camera Body

Front

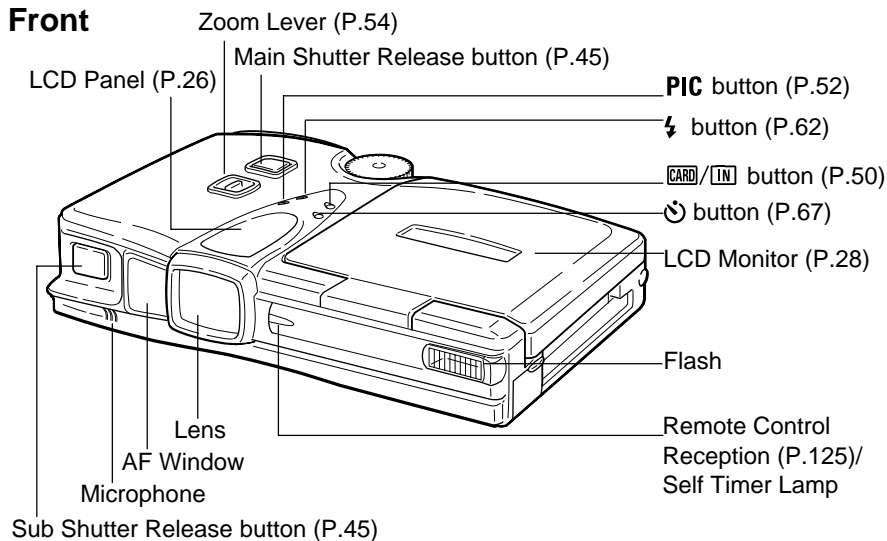

Back

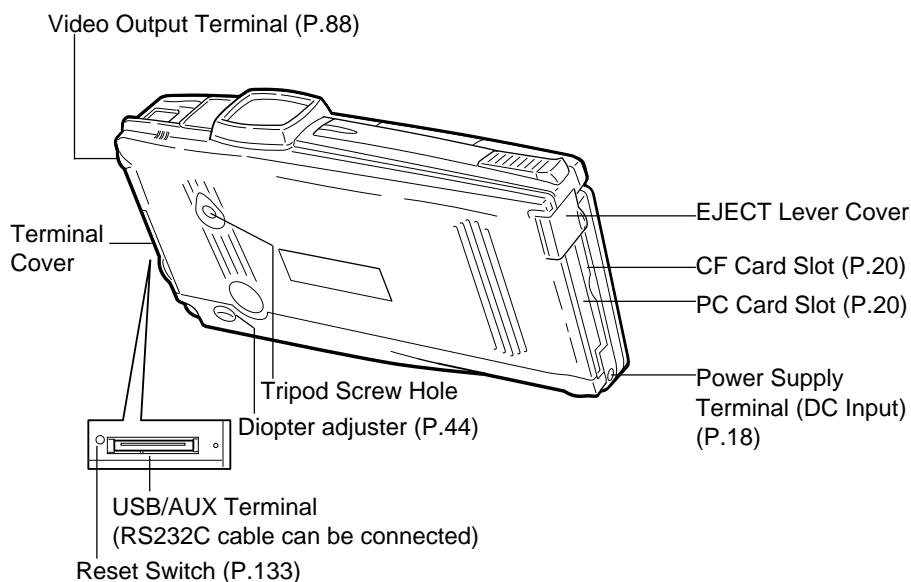

Operating Parts

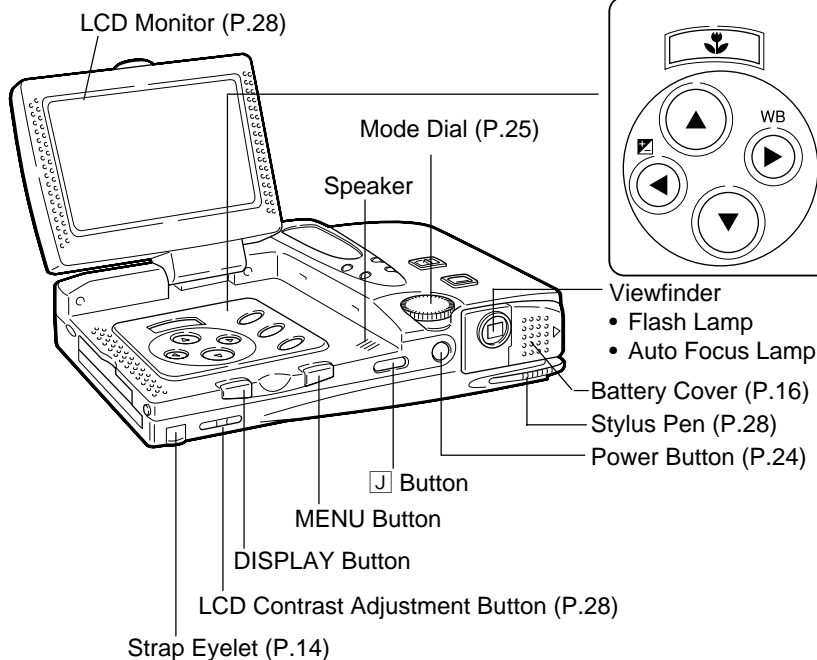

Operation Panel

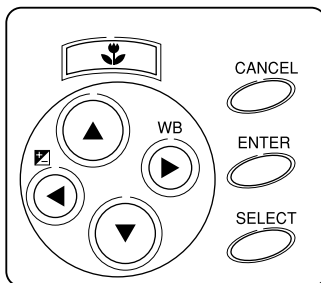

■ Battery/Battery Charger

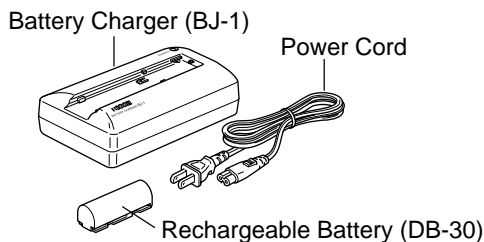

■ AC Adapter (optional)

- AC-3 (100 V – 240 V)

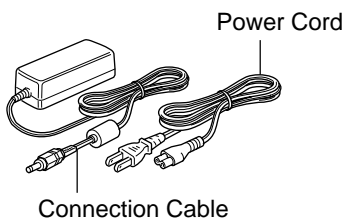

■ Remote Control Unit (optional)

- DR-3

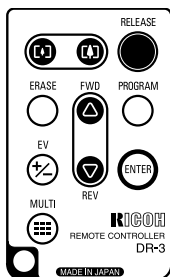

Safety Precautions

Warning Symbols

Various symbols are used throughout this operation manual and on the product to prevent physical harm to you or other people and damage to property. The symbols and their meanings are explained below.

Warning

This symbol indicates matters that may lead to death or serious injury if ignored or incorrectly handled.

Caution

This symbol indicates matters that may lead to injury or physical damage if ignored or incorrectly handled.

Sample Warnings



The  symbol alerts you to actions that must be performed.



The  symbol alerts you to prohibited actions.

The  symbol may be combined with other symbols to indicate that a specific action is prohibited.

● **Examples**



Do not touch



Do not disassemble

Observe the following precautions to ensure safe use of this equipment.

Warning



- Turn off the power immediately in the event of irregularity, such as the equipment emitting smoke or a strange smell. Remove the battery as soon as possible, being careful to avoid electric shocks or burns. If you are drawing power from a household electrical outlet, be sure to unplug the power cord from the outlet to avoid fire or electrical hazards. Discontinue use of the equipment immediately if it is malfunctioning. Contact the nearest service center at your earliest convenience.

Warning



- Turn off the power immediately if any metallic object, water, liquid or other foreign object gets into the equipment. Remove the battery as soon as possible, being careful to avoid electric shocks or burns. If you are drawing power from a household electrical outlet, be sure to unplug the power cord from the outlet to avoid fire or electrical hazards. Discontinue use of the equipment immediately if it is malfunctioning. Contact the nearest service center at your earliest convenience.



- Avoid any contact with the liquid crystal inside the LCD monitor, should the monitor be damaged. Follow the emergency measures below in the following circumstances.
 - SKIN: If any of the liquid crystal gets on your skin, wipe it off and rinse the affected area thoroughly with water, then wash well with soap.
 - EYES: If it gets in your eyes, wash your eyes with clean water for at least 15 minutes and seek medical advice immediately.
 - INGESTION: If any of the liquid crystal is ingested, rinse the mouth out thoroughly with water. Have the victim drink a large amount of water and induce vomiting. Seek medical assistance immediately.



- Follow these precautions to prevent the battery from leaking, overheating, igniting or exploding.
 - Do not use a battery other than that specifically recommended for the equipment.
 - Do not carry or store the battery with metallic ballpoint pens, necklaces, coins, hairpins, etc.
 - Remove the battery from the camera or battery charger immediately in the event of irregularity, such as a strange smell or discoloration, during use or recharging.

Warning



- Observe the following precautions to prevent fire, electric shock or explosion caused by the battery charger.
 - Do not use a power source voltage other than that indicated. Avoid putting several loads on one power outlet or using an extension cable.
 - Do not cut, damage, tie in a bundle or alter the power cord. Do not place heavy objects on the power cord, pull it or bend it excessively.
 - Do not plug or unplug the power cord with wet hands. When unplugging the power cord, be sure to hold the plug.
 - Do not wrap the battery in cloth, etc.



- Keep the battery used in this equipment out of the reach of children to prevent accidental ingestion. Consumption is harmful to human beings. If swallowed, seek immediate medical assistance.



- Keep the equipment out of the reach of children. Their inability to read and understand warning and safety precautions may lead to accidents.



- Do not touch the internal components of the equipment if they become exposed as a result of being dropped or damaged. The high-voltage circuitry in the equipment could lead to an electric shock. Remove the battery as soon as possible, being careful to avoid electric shocks or burns. Take the equipment to your nearest dealer or service center if it is damaged.



- Do not attempt to disassemble, repair or alter the equipment yourself. The high-voltage circuitry in the equipment poses a significant electrical hazard.



- Do not use the equipment in the kitchen or bathroom where it would be exposed to steam or humidity as this could result in fire or electric shock.



Warning



- Do not use the equipment near flammable gases, gasoline, benzene, thinner or similar substances to avoid the risk of explosion, fire or burns.
- Do not use the equipment in aircraft or other locations where usage is restricted or prohibited as this may lead to disasters or accidents.



- Wipe off any dust that accumulates on the electrical plug as this may lead to fire.
- Use only the specified AC adapter for this equipment (optional AC-3) in household electrical outlets. Other adapters pose the risk of fire, electric shock or failure.



- To avoid the risk of fire, electric shock or failure, do not use the AC adapter with commercially available electronic transformers when traveling abroad.

Observe the following precautions to ensure safe use of this equipment.

Caution



- Contact with fluid leaking from the battery can lead to burns. If part of your body comes in contact with a damaged battery, wash the area with water immediately. (Do not use soap.) If the battery starts to leak, remove it from the equipment and wipe the battery chamber thoroughly before replacing it with a new battery.



- Plug the power cord securely into the electrical outlet. Loose cords pose a fire hazard.



- Do not allow the camera to get wet. In addition, do not operate it with wet hands. Both pose the risk of electric shock.



- Do not fire the flash at drivers of vehicles such as bicycles, cars and trains, as this may cause the driver to lose control and result in a traffic accident.

Safety Warning for Accessories

- Safety warnings for the optional accessories such as the remote control unit and AC adapter are contained in the operation manual provided with each product and should be read thoroughly before operating the equipment.

Chapter 1

Getting Started

Before Using the Camera	14
Attaching the Neck Strap	14
Attaching the Lens Cap	14
Powering the Camera	15
Charging the Battery	15
Loading the Battery	16
Connecting an AC Adapter	18
Storage Memory	19
Inserting a CF Card or PC Card ...	20

Before Using the Camera

Before using the camera, attach the neck strap, and lens cap.

Attaching the Neck Strap

- 1 Pass the small loop of the strap through the strap eyelet and pass the other end through the loop as illustrated.

Remove the strap from the buckle first and pass each loop through the strap eyelet.

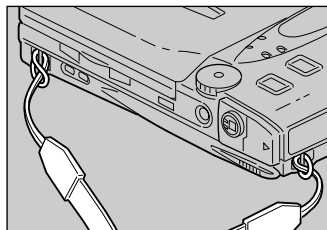

- 2 Pass the strap through the buckle and adjust the length of the strap.



- Do not swing the camera around by its strap.

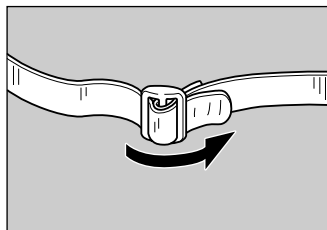

Attaching the Lens Cap

- 1 Push the lens cap on in the direction shown by the arrow.

To remove the lens cap, take hold and push off.



- Attach the lens cap to the strap to prevent it being lost.

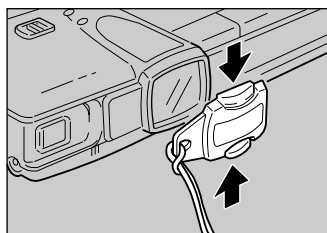

Powering the Camera

This section explains how to load and recharge the battery and how to power the camera from a household electrical outlet.

Charging the Battery

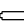
When using the battery for the first time or when the  battery symbol is displayed, follow the procedure below and charge the battery to its full capacity.

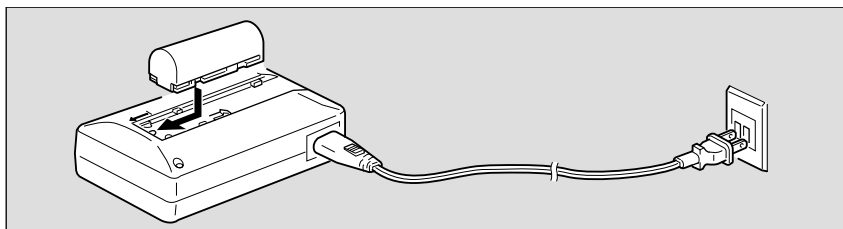

1 Set the battery in the battery charger.

2 Insert the power plug into an electrical outlet.

Charging will start and the battery can be charged as shown in the table below. When charging is finished, remove the power plug from the electrical outlet.

CHARGE(Charging) Lamp	Explanation
Lights red	Charging starts
Lights green	100-minute charging has finished (battery is 90% charged) * If you are in a hurry, the battery can be used at this point.
Green light goes off	Battery is fully charged after charging for about 50 minutes after lamp lights green

■ Precautions Regarding Use

- Use only the specified battery (DB-30).
- Use only the specified battery charger (BJ-1) to charge the battery.
- Do not use the battery charger to charge batteries other than the DB-30 battery.
- Charge the battery in a well ventilated place with an ambient temperature in the range of 10°C to 40°C (50°F to 104°F).
- When the battery approaches the end of its service life, its operating time becomes shorter even when properly charged. Replace with a new battery.
- The battery may feel warm after charging, but this is not a malfunction.
- After charging is finished, remove the power plug from the electrical outlet. Leaving the plug in the outlet may result in fire.

Loading the Battery

Load the rechargeable lithium ion battery (DB-30) to operate the camera.



- When using the camera for the first time, be sure to charge the battery. (The battery is not charged when the camera leaves the factory.) → P.15 “Charging the Battery”

- 1 Check that the camera is turned off, and then open the battery cover by pressing the catch and sliding it in the direction shown.



- P.24 “Turning On/Off the Camera”

- 2 Load the battery.



- Do not bring metallic objects into contact with the battery contact surfaces or electrical connections. Electrostatic damage could result.

- 3 Close the battery cover.

Close the battery cover until it clicks into position.

● Shooting and Playback Guidelines

The table below gives the approximate recording and playback times that are available, as measured under the following test conditions.

[Test conditions]

During shooting: Shoot continuously in a recording mode (shoot at intervals of 30 seconds, without turning the camera off in the middle, with the flash fired 50%, at an ambient temperature of 20°C (68°F).

During playback: Leave the camera continuously turned on in a playback mode at an ambient temperature of 20°C (68°F).

Battery Type	Approximate Recording Time	Approximate Playback Time
Lithium ion battery (fully charged)	50 minutes	60 minutes

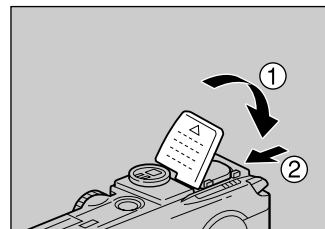
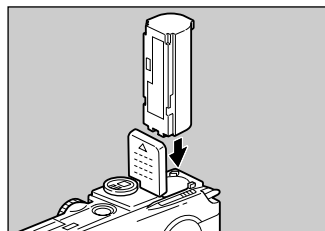
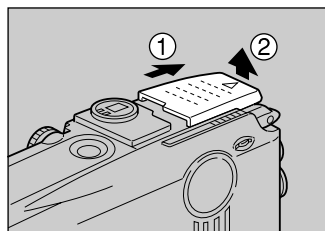

Tips to Extend the Recording and Playback Times

- The battery lives indicated on the previous page may decrease depending on the ambient environment.
In an extremely cold environment, warming the battery by hand, for example, may allow you to take more pictures.
- Increased use of the flash or zoom feature or the LCD monitor may speed up the exhaustion of the battery. Reduce their usage to a minimum.
- Copying or erasing images repeatedly may also accelerate the exhaustion of the battery.
- Taking pictures with the LCD monitor display turned off will help to extend the life of the battery.

■ Handling Precautions

- Before using the battery, be sure to read the accompanying operation manual.
- Use the specified battery. → P.137 “Accessories”
- Wipe the terminals of the battery and the contacts of the camera with a dry cloth.
- Continued use of the battery for long periods may cause the battery to become hot. Wait until it cools before removing it.
- Store the battery charger and the battery separately except when charging.
- Store the battery in the case provided.
- When not using the camera for a long period of time, discharge the battery completely before removing it, and store it in a cool place. Before using the camera again, fully charge the battery.



- If a power source is available nearby, you can economize on the battery by using an AC adapter (optional). → P.18 “Connecting an AC Adapter”
- You are advised to have a spare battery available when powering the camera from the battery alone.
- When the  battery symbol appears on the LCD panel, it indicates that the battery voltage is low. Recharge the battery. → P.15 “Charging the Battery”

Connecting an AC Adapter

When using the camera for extended periods of time to shoot or playback images, or connecting with a PC, connect an AC adapter (optional) to the camera and power the camera from a household electrical source.

Using the AC Adapter

Before using the AC adapter, be sure to read the safety precautions in the accompanying manual.

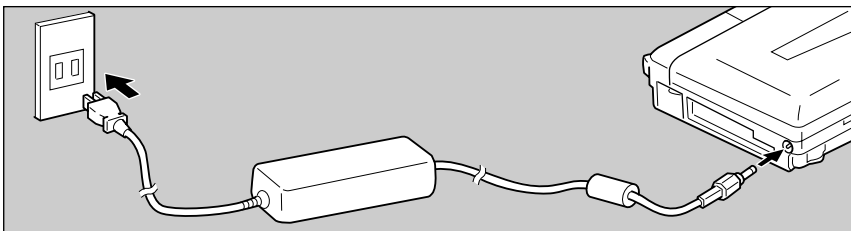

- 1 Check that the camera is turned off, and connect the AC adapter connection cable to the power supply terminal (DC input) on the camera.

See • P.24 “Turning On/Off the Camera”

- 2 Insert the power plug into the electrical outlet.

Note • If the battery is loaded in the camera while it is connected to a household power source, the camera is powered from the AC source and not by the battery. If the AC adapter is to be used for a long time, remove the battery.

Important Note

- Insert the power plug and connection cable securely. If the plug or cable works loose during recording, the data may be lost or damaged.
- If you connect or disconnect the AC adapter while operating the camera (recording, playback, or erasing), the camera will switch off to determine the power source. This may cause the data to be lost or damaged. To avoid this, connect or disconnect the AC adapter while the camera is turned off.

Storage Memory

Files shot with this camera can be recorded on the following three types of memory:

Storage Memory	Capacity
CF card	16 MB, 32 MB, 48 MB, 64 MB, 96 MB, 128 MB (3.3 V)
PC card	5 MB, 10 MB (3.3 V, Ricoh-brand)
Internal memory	Max. 6 MB

Note • Use a recommended memory card. → See the separate list of Qualified Products.

■ Handling Precautions

- Never remove the CF card or PC card while data is being recorded or erased.
- Do not bend, subject to strong force or shock, or drop the CF card or PC card.
- Avoid using or storing memory cards in environments that are subject to static electricity or electrical interference.
- Avoid using or storing memory cards in environments that are subject to high temperature and humidity, where dust accumulates, or in atmospheres where corrosive substances are present.
- Keep the card slot free from dust or foreign matter.
- To avoid possible hazards, keep memory cards away from flames and do not dispose of them in fire.
- Memory cards have a limited service life. Cards that have been used over an extended period of time may fail to record additional files.

■ Data

- Data recorded on a CF card or PC card may be lost by improper handling by the customer or a third party, by being subjected to static electricity or electrical interference, or during camera malfunction or repair. Ricoh Co., Ltd. assumes no liability for damages incurred by such loss of recorded data.
- Do not remove the battery from the camera, turn off the camera, or connect the AC adapter while data is being recorded on the CF card or PC card. The data stored on the memory card could be lost or damaged.
- You are advised to copy valuable data from the memory card onto other memory, such as floppy disks or hard disks.

Inserting a CF Card or PC Card

Check that the camera is turned off before inserting the CF card or the PC card.



- Be sure to turn the power off before inserting or removing the card, otherwise the data on the card may be lost or damaged and the camera may malfunction.
- Before using a new card or a card that has been used on another device (such as a PC), you need to format (initialize) it with the camera. → P.43 "Formatting the Storage Memory"
- Do not remove the PC card while data is being recorded or erased. The data stored on the card could be lost or damaged.

■ Inserting Card

① Check that the camera is turned off.



• P.24 "Turning On/Off the Camera"

② Insert the card into the card slot.

● Inserting CF card

Push the CF card into the upper card slot fully into position, with the label surface facing up.

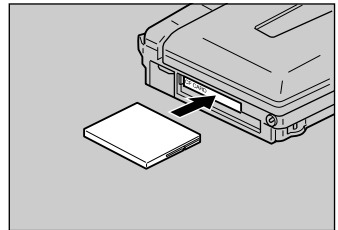

● Inserting the PC card

Push the PC card into the lower card slot fully into position, with the label surface facing up.

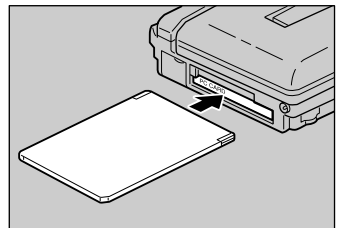

■ Removing Card

- ① Check that the camera is turned off, and then open the EJECT lever cover.

See • P.24 “Turning On/Off the Camera”

- ② Turn the CF or PC card EJECT lever in the direction shown by the arrow and press it.

- CF card

Press the upper EJECT lever.

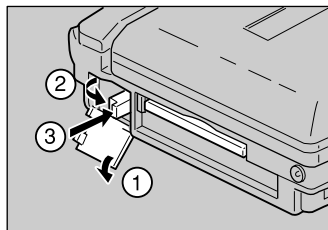

- PC card

Press the lower EJECT lever.

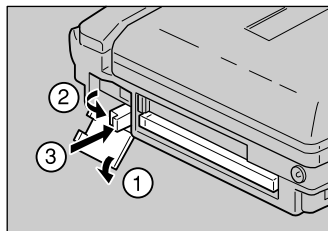

- ③ Pull the CF or PC card straight out of the slot.

- CF card

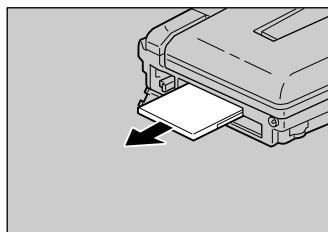

- PC card

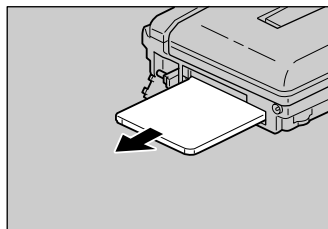

- ④ Return the CF or PC card EJECT lever to its original position and close the EJECT lever cover.



SmartMedia Memory Cards

This camera can record images stored on a SmartMedia memory card by using a PC card adapter (optional).

The following types of SmartMedia memory card can be used:

- Capacity: 2 MB, 4 MB, 8 MB, 16 MB, 32 MB, 64 MB
- Operating voltage: 3.3 V

Insert the SmartMedia memory card into the PC card adapter.

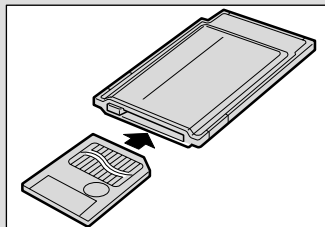

Insert the PC card adapter into the camera.

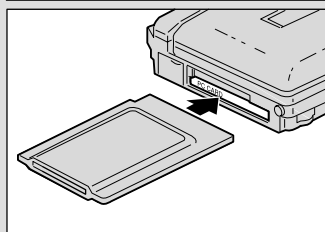

Be sure to read the accompanying manual before using a SmartMedia memory card or PC card adapter.

*** Do not insert or remove the SmartMedia memory card while the PC card adapter is being attached to the camera. The SmartMedia card could be damaged.**

*** Use of the SmarMemory may restrict some functions of the camera.**