

# GETTING STARTED Chapter

# 1

<b>Before Using the Camera .....</b>	<b>26</b>
<b>Checking the Package Contents .....</b>	<b>26</b>
<b>Attaching the Wrist Strap .....</b>	<b>26</b>
<b>Powering the Camera .....</b>	<b>27</b>
<b>Loading the AA Batteries .....</b>	<b>27</b>
<b>Using an AC Adapter .....</b>	<b>29</b>
<b>SmartMedia Memory Cards .....</b>	<b>31</b>
<b>What is a SmartMedia Memory Card? .....</b>	<b>31</b>
<b>Inserting a SmartMedia Memory Card .....</b>	<b>32</b>
<b>Formatting a SmartMedia Memory Card .....</b>	<b>33</b>
<b>Before You Start Recording .....</b>	<b>35</b>
<b>Setting the Date and Time .....</b>	<b>35</b>
<b>Adjusting the LCD Monitor Brightness .....</b>	<b>37</b>
<b>How to Hold the Camera .....</b>	<b>37</b>

# Before Using the Camera

## Checking the Package Contents

Check that your digital camera comes complete with all the accessories listed below. Read the warranty card and keep it in a safe place.

- Digital camera: ..... 1
- Video interface cable: ..... 1
- Soft case: ..... 1
- AA alkaline batteries: ..... 4
- Wrist strap: ..... 1
- Operation manual (this manual): ..... 1
- Warranty card: ..... 1
- PC connection cable (RS-232C) ..... 1
- Macintosh cable (AUX) ..... 1
- USB cable ..... 1
- Software CD-ROM ..... 1

## Attaching the Wrist Strap

Attach the wrist strap provided to prevent the camera from being dropped during use.

- 1 Pass the small loop of the strap through the wrist strap eyelet and pass the other end through the loop as illustrated.



- Do not swing the camera around by its strap.

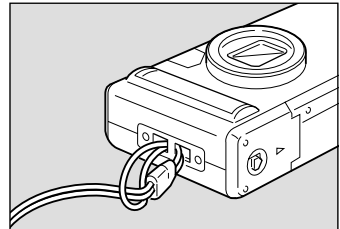

# Powering the Camera

This section explains how to load the batteries (AA alkaline batteries) into the camera and how to connect the AC adapter to power the camera from a household electrical outlet.

## Loading the AA Batteries

Mount AA batteries and operate the camera.



- If you use commercial batteries, use of rechargeable AA batteries (nickel-cadmium or nickel-metal-hydride batteries) is recommended.

### Rechargeable Batteries

- Before using commercially available rechargeable AA Ni-Cd or AA Ni-MH batteries, read the safety precautions in the accompanying manual.



- Use only the specified AA batteries.
- Never use batteries of an unrecommended type, such as manganese battery, as this could damage the camera or LCD monitor and cause them to fail.
- Certain types of batteries may become hot after an extended period of use. Allow them to cool before unloading them.
- Do not use commercially available batteries that are designed for specific kinds of equipment (such as those marked "For CD players only") in this product.
- When purchasing batteries, read the battery instructions carefully to make sure that they can be used for this product.
- Remove the batteries from the camera before leaving it out of service for long.

- 1 Check that the camera is turned off, and then open the battery cover by pressing the catch and sliding it in the direction shown.

**See** "Turning on the Camera" (p.41)

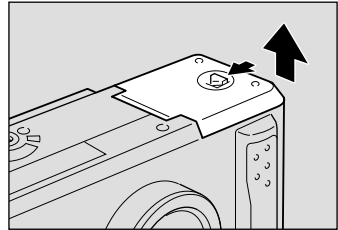

- 2 Load the batteries.



- Make sure that the batteries are loaded with the positive (+) and negative (-) terminals correctly oriented. Do not bring metallic objects, such as a needle, into contact with the battery contact surfaces or electrical connections. Electrostatic damage could result.

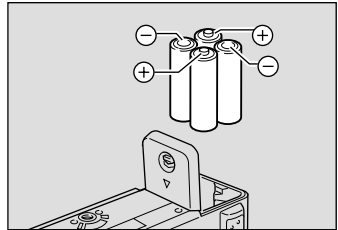

- 3 Close the battery cover

Close the battery cover until it clicks into position.

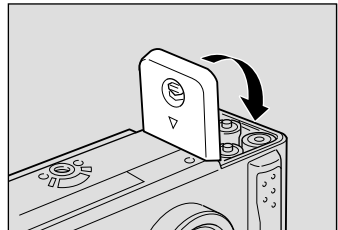

## ■ Economizing on Batteries

Use of rechargeable Size AA Ni-Cd or AA Ni-MH batteries is recommended for most applications.

If a power source is available nearby, you can economize on the batteries by using an AC adapter (optional).

In shooting pictures, having the LCD monitor display turned off will help your batteries longer-lived.

## ● Shooting and Playback Guidelines

The table below gives the approximate recording and playback times that are available with Size AA alkaline batteries, as measured under the following test conditions:

[Test conditions]

During shooting: Shoot continuously in a recording mode (shoot at an interval of 30 seconds, without turning off the camera in the middle, with the flash fired 50%, at a 25<sup>TM</sup>/ambient temperature).

During playback: Leave the camera continuously turned on in a playback mode at a 25<sup>TM</sup>/room temperature.

Battery type	Approximate Recording Time	Approximate Playback Time
Size AA alkaline batteries	60 minutes	90 minutes
Ni-Cd batteries (1000 mAh)	40 minutes	60 minutes

### Tips to Extend the Recording and Playback Times

- \* The battery lives indicated above tend to narrow depending on the ambient environment.
- \* In an extremely cold environment, warming the batteries by hand, for example, could allow you to take more pictures. Where the ambient temperature is extremely low, use of rechargeable Ni-Cd batteries is recommend for their cold resistance.
- \* Choose rechargeable batteries having as high a capacitance as possible. (The capacitance rating is marked in the unit mAh.)
- \* Increased use of the flash or zoom feature or the LCD monitor would speed up the exhaustion of the batteries. Cut their usage to a minimum required.
- \* The available picture count tends to increase when they are recorded in the 900 × 600 recording mode.
- \* Copying or erasing images repeatedly would also accelerate the exhaustion of the batteries.

- Note** • You are advised to make spare batteries available when powering the camera from the internal batteries alone.
- The battery symbol (⎓), when lit, indicates that the camera's internal batteries have a diminishing voltage. Make spare batteries available.
- ( Rechargeable Size AA Ni-Cd and Ni-MH batteries have a characteristic tendency to turn off their power immediately when the battery symbol is lit. )

## ■ Handling Precautions

- Do not use damaged batteries or batteries at the end of their service lives.
- Do not subject the batteries to strong impacts .

## Using an AC Adapter

When using the camera for extended periods of time to shoot or playback images, connect an AC adapter (optional) to the camera and power the camera from a household electrical source.

### Using the AC Adapter

Before using the AC adapter, be sure to read the safety precautions in the accompanying manual.

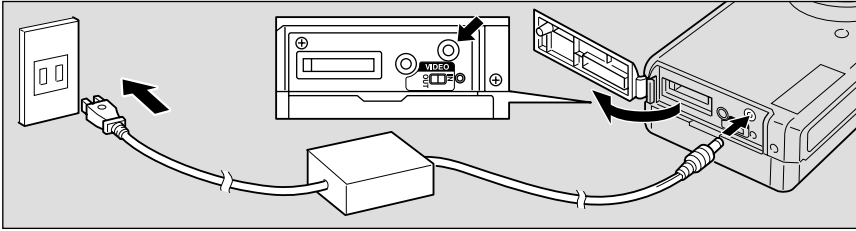

**1 Check that the camera is turned off, and then open the terminal cover.**

**See** “Turning on the Camera” (p.41)

**2 Connect the AC adapter cable to the power supply terminal (DC input) on the camera.**

**3 Insert the power plug into the electrical outlet.**

**Note** • If batteries are loaded in the camera while it is connected to a household power source, the camera is powered from the AC source and not by the batteries.

**Important Note**

- Insert the power plug and connection cable securely. If the plug or cable works loose during recording, the data may be lost or damaged.
- If you connect or disconnect the AC adapter while operating the camera (recording, playback, or erasing), the camera will switch off to determine the power source. This may cause the data to be lost or damaged. To avoid this, connect or disconnect the AC adapter while the camera is turned off.

# SmartMedia Memory Cards

This section explains the types and usage of SmartMedia memory cards.

## What is a SmartMedia Memory Card?

Files are recorded as data on the SmartMedia memory card in your camera. The following types of SmartMedia memory card can be used:

- Capacity: ..... 2 MB, 4 MB, 8 MB, 16 MB, 32 MB
- Operating voltage: .... 3.3 V

- Note**
- There are numerous types of SmartMedia memory cards. Before using a commercially available SmartMedia memory card, check with its manufacturer that it is compatible with your camera.
  - By using an optional PC card adapter or floppy disk adapter, you can insert a SmartMedia memory card directly into the PC card slot or floppy disk drive of your PC.

## ■ Protecting Against Accidental Writing

Attaching a write protect pad to a SmartMedia memory card will prevent accidental erasure or overwriting of recorded files.

Remove the write protect pad from the SmartMedia memory card to record or erase data.

- Note** If the write protect pad gets dirty, wipe it clean with a soft, dry cloth.

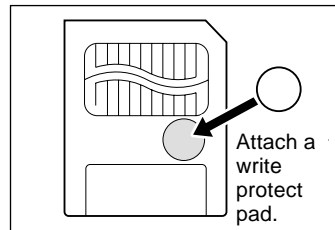

## ■ Handling Precautions

### ● SmartMedia Memory Cards

- Never remove the SmartMedia memory card while data is being recorded or erased.
- Do not bend, subject to strong force or shock, or drop the SmartMedia memory card.
- Avoid using or storing SmartMedia memory cards in environments that are subject to static electricity or electrical interference.
- Avoid using or storing SmartMedia memory cards in environments that are subject to high temperature and humidity, where dust accumulates, or in atmospheres where corrosive substances are present.
- Keep the contact surface of the SmartMedia memory card clean and free from dust and foreign matter. Should the contact surface get dirty, wipe it clean with a soft, dry cloth.

- Keep the SmartMedia memory card slot free from dust and foreign matter.
- To avoid possible hazards, keep SmartMedia memory cards away from flames and do not dispose of them in fire.
- SmartMedia memory cards have a limited service life. Cards that have been used over an extended period of time may fail to record additional files.

● **Data**

- Data recorded on a SmartMedia memory card may be lost by improper handling by the customer or a third party, by being subjected to electricity or electrical interference, or during camera malfunction or repair. Ricoh Co., Ltd. assumes no liability for damages incurred by such loss of recorded data.
- Do not remove the batteries from the camera, turn off the camera, or connect the AC adapter while data is being recorded on the SmartMedia memory card. The data stored on the SmartMedia memory card could be lost or damaged.
- You are advised to copy valuable data from the SmartMedia memory card onto other media, such as floppy disks or hard disks.

## Inserting a SmartMedia Memory Card

Check that the camera is turned off before inserting the SmartMedia memory card.



- Never insert or remove a SmartMedia memory card while the camera is turned on.

### ■ Inserting Card

- 1 Check that the camera is turned off, and then open the card door.

**See** "Turning on the Camera" (p.41)

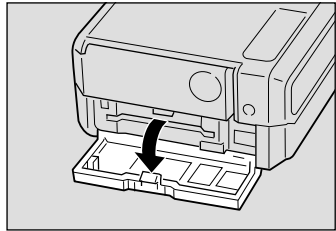

- 2 Insert the SmartMedia memory card into the card insert slot and close the card door.

Push the SmartMedia memory card fully into position, with the contact surface facing up.

Contact surface

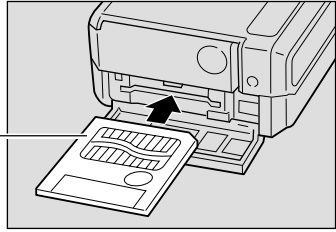





- Insert the SmartMedia memory card in the correct direction. Do not insert it at an angle.
- The camera will not turn on when the card door is open.

## ■ Removing Card

- 1 Check that the camera is turned off, and then open the card door.



“Turning on the Camera” (p.41)

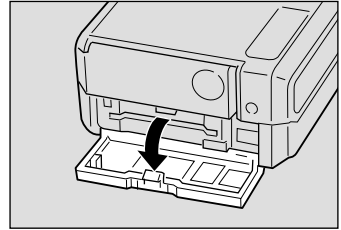

- 2 Press the button and pull the SmartMedia memory card straight out of the slot.

Pressing the button will cause the SmartMedia memory card to pop out a little. Then, pull it straight out of position.

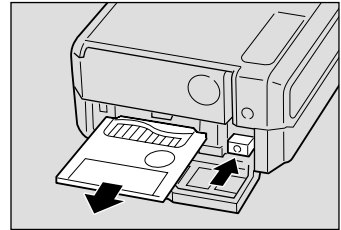

- 3 Close the card door.



- Never remove the SmartMedia memory card while data is being recorded or erased. The data stored on the card could be lost or damaged.
- When the SmartMedia memory card has been removed, place it in the antistatic case supplied or other protective cover.

## Formatting a SmartMedia Memory Card

Before using a new SmartMedia memory card or a SmartMedia memory card that has been used on another device (such as a PC), you need to format (initialize) it with the camera.



- Formatting will erase all the files recorded on the SmartMedia memory card (including protected files).
- Do not format SmartMedia memory cards on a PC.
- The SmartMedia formatted by the other device may not be used.

- 1 Insert the SmartMedia memory card and slide the power switch to turn on the camera.

**See** “Inserting a SmartMedia Memory Card” (p.32)  
“Turning On the Camera” (p.41)

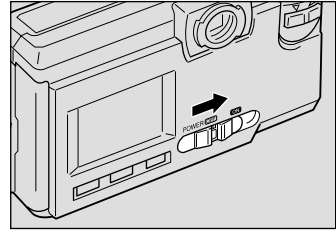

- 2 Set the mode dial to [SETUP].  
The setup menu will be displayed.

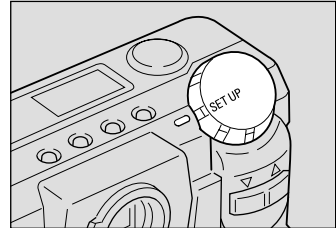

- 3 Press the **▲** or **▼** button to select [FORMAT] and press the ENTER button.

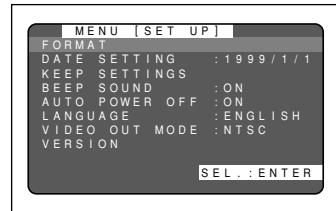

- 4 Press the **▲** or **▼** button to select [FORMAT MEMORY CARD] and press the ENTER button.

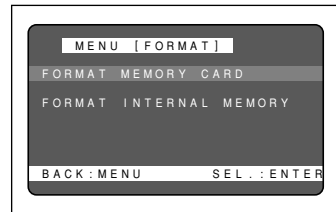

- 5 Press the shutter release button.  
The “FORMATTING” message is displayed while the camera is formatting the SmartMedia memory card.

When formatting is completed, the setup menu will reappear. Turn the mode dial to choose another mode.

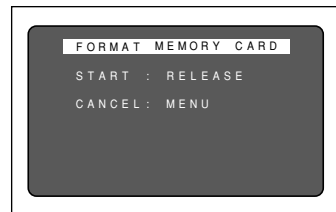

**Note** • A SmartMedia memory card with a write protect pad attached to it cannot be formatted. Remove the pad to format the SmartMedia memory card.

# Before You Start Recording

This section explains the initial camera adjustments and pointers you should know before starting to record pictures.

## Setting the Date and Time

The date and time are recorded when you shoot a picture. You will need to adjust these settings when you first use the camera and each time you change time zones on trips.

- Note**
- Use the yy/mm/dd format to set the date.
  - Time is displayed in the 24-hour clock format. Midnight is expressed as 00:00 and noon as 12:00.

**1** Slide the center button of power switch to turn on the camera.

- See** "Turning On the Camera" (p.41)

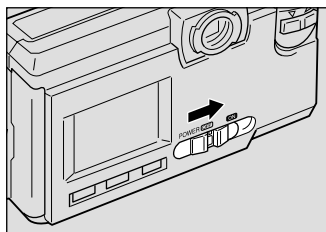

**2** Set the mode dial to [SETUP].

The setup menu is displayed.

- Note**
- To cancel the operation, turn the mode dial to another mode.

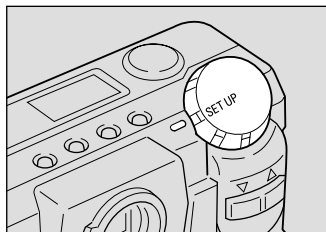

**3** Press the **OK** or **DISP** button to select [DATE SETTING].

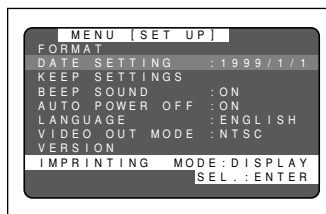

**4 Press the DISPLAY button to select the date display method.**

There are three methods available to display the date as follows:

1999/5/15 → May 15 1999 → 15 May 1999

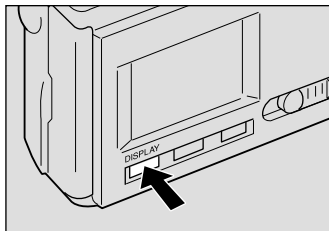

Each time you press the DISPLAY button, the display method is switched from one position to the next in the sequence shown above. Press the DISPLAY button to select the desired date display method.



**5 Press the ENTER button.**

The date setting menu is displayed.

- Note** • To cancel the operation and return to the setup menu, press the MENU button.

**6 Press the  or  button to change the flashing digit.**

**Forwarding the digit**

Press the  button. Keep pressing the button to forward the digit fast.

**Reversing the digit**

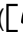
Press the  button. Keep pressing the button to reverse the digit fast.

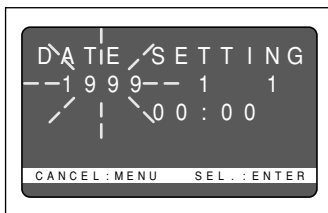

**7 Press the ENTER button to flash the digit you want changed.**

Repeat steps 6 and 7 above to make necessary corrections.

- Note** • Each time you press the ENTER button, the flashing digit changes, from year to month, day, hour and minute.

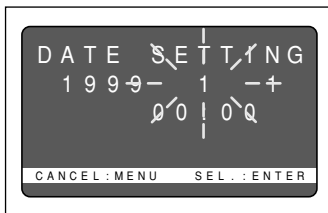

**8 After you have set the number of minutes, press the ENTER button again.**

The clock gets started and the LCD monitor returns to the SET UP menu. Turn the mode dial to select another mode.

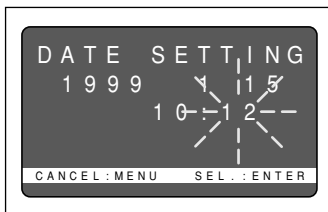

**Note**

- You can set the time correctly by pressing the ENTER button at the same time as a time signal sounds.
- Press the MENU button in the middle of an operation to cancel it.
- The date and time settings are reset if the battery has been removed for about 3 minutes or longer, as at replacement. Set the date and time again.

**Tips****How to Verify the Date and Time**

Press the ENTER button to view the date and time settings in the LCD monitor for verification. See “LCD Monitor Display Function” (p.50).

## Adjusting the LCD Monitor Brightness

You can adjust the brightness setting of the LCD monitor.

- 1 Turn the brightness adjustment dial on the bottom of the camera, left or right to adjust the LCD monitor brightness to a favorable setting for viewing.

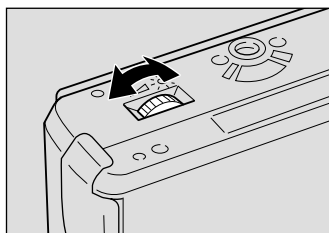

## How To Hold the Camera

Unintentional movement of the camera during shooting will result in blurred images. To avoid camera shake, hold the camera in the fashion prescribed below. Be particularly careful to avoid camera shake with telephoto zoom shots.

- 1 Hold the camera steady with both hands with the elbows lightly touching your body.
- When viewing through the viewfinder  
With the camera lightly pressed against your head, aim it at your subject and look through the viewfinder.

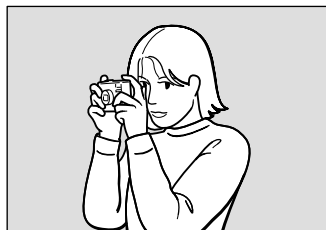

● **When viewing through the LCD monitor**

Hold the camera firmly in both hands, and aim it at your subject and look through the LCD monitor.

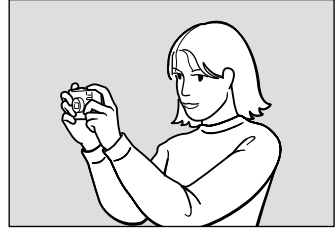

② **Press the shutter release button lightly with your fingertip.**

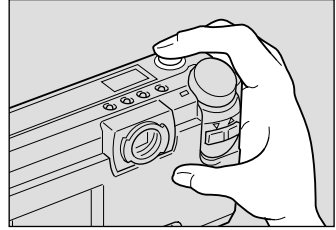

- Pressing the shutter release button at once with the finger initially apart from it could result in a blurred image.



- When an image of a subject that has been shot with the camera held in vertical position is played, the subject will look sideways.

Be careful to keep the camera lens, flash, and the flash sensor reception window from being covered by your fingers or hair.

