

RICOH

DIGITAL CAMERA
Caplio GX100



f=24mm, 1/8sec, F4.6, ISO100, EV-1, Full size photo, no trimming

24-72mm/F2.5(W)-4.4(T)



1/1.75-inch type 10 Megapixels CCD

All lens focal lengths indicated in this catalog are 35mm camera equivalent values.



f=24mm, 1/189sec, F5.7, ISO100, EV-0.7, Full size photo; no trimming

It's more than an expanded lens angle. It's a whole new vision of the world.

Versatile imagery from a 24-72mm optical zoom lens

The GX100's slender body accommodates a 24-72mm/f2.5(W)-4.4(T), 3x wide-angle optical zoom lens. Set to wide-angle it can be utilized for wide-perspective pan focus shooting and versatile photographic effects. At medium distances, it is effective for taking portraits or framing scenes. With the freedom to compose and wide potential for expression, the Caplio GX100 appeals to the type of photographer who seeks to enhance his expressive artistry.

Superb optical performance, all the way to the picture's edge

Striving for compact size and outstanding imagery from its 24mm wide-angle zoom lens, the Caplio GX100 boasts a high-performance lens utilizing aspherical, special low-dispersion glass lenses with a high refractive index, in a high-quality 7-group, 11-element configuration. This design effectively suppresses distortion, color aberration and light falloff at the edges. As the MTF (Modulation Transfer Function) curve demonstrates, it achieves high definition and high contrast reproduction all the way to the edges.

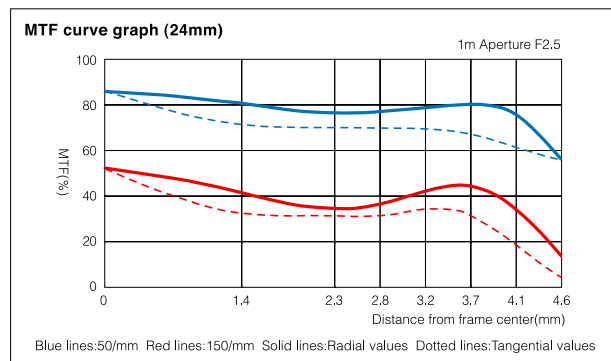
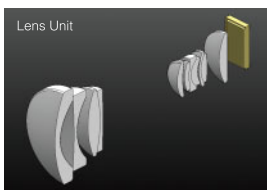

Wide-angle conversion lens

Attach the DW-6* wide conversion lens (optional) and you'll get a perspective even wider than the naked eye, enabling you to take ultra-wide-angle shots with a 19mm focal length. The ability to shoot extreme déformé perspectives and wide angle shots give further vent to original shooting. The wide conversion lens requires the easily-connected HA-2* adapter, which also permits attachment of the lens hood and a variety of 43mm diameter filters (standard items).



* Optional * When wide conversion lens is attached, the built-in flash cannot be used as vignetting may occur.

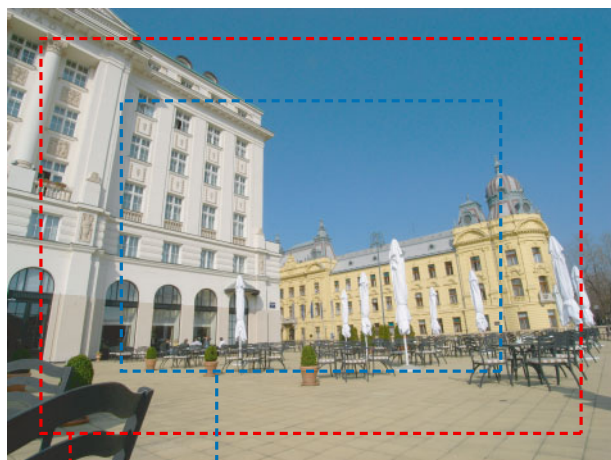

Equivalent to 24mm Equivalent to 35mm With use of 19mm wide conversion lens (DW-6), 1/640sec, F7.2, ISO100, Full size photo; no trimming

Seven-blade iris aperture realizes striking blur tone

Selectable in 12 steps from fully open to the smallest setting, the odd-numbered 7-blade iris aperture enables close control over exposures. At any setting a nearly perfect circle is achieved, permitting capture of gorgeous blur tones and shafts of light.

User-detachable LCD viewfinder*1

GX100 boasts a unique removable electronic viewfinder. As the same parallax displayed by the LCD monitor is eliminated, the field of view is 100 percent, enabling framing with the same sense of accuracy as a single-lens reflex camera. Its tilt mechanism*1 permits low-angle shots, for even more photographic creativity.

*1 During tilt, the built-in flash cannot be utilized.



at normal setting



during tilting

Step zoom emulates single focal length lenses

The zoom lens' focal length can be fixed at 24/28/35/50 and 72mm. This step zoom system gives the sensation of lenses used on 35mm cameras.

10.01-megapixel CCD achieves fine, detailed imagery

The GX100's CCD, boasting 10.01 megapixels with superb definition, incorporates Ricoh's original "Smooth Imaging Engine II" for natural color rendition with low noise. Combining these two strengths, the GX100 achieves fine, detailed quality images that stand up to demanding enlargements. A choice of F (Fine), N (Normal) and RAW mode settings are available, with RAW recommended for processing the image with computer software as well as for optimal picture quality.



f=34mm, 1/200sec, F2.9, ISO100, Full size photo; no trimming

A camera that anticipates its user's feelings and intentions



f=44mm, 1/380sec, F4.6, ISO100, Full size photo; no trimming

Vibration correction and high-sensitivity auto setting, for capturing images with sharpness

A CCD shift-type vibration correction function has been adopted, to enable sharply defined hand-held shots even in low-light situations or where use of flash is prohibited. Vibration correction is also effective for capturing atmospheric shots that harness the light and shadow as-is. By setting the GX100 to the AUTO-HI position, the camera's ISO sensitivity is automatically boosted. As shutter speed is raised, this prevents blurring of the subject. Combines with the vibration correction it makes for distinctive, sparkling pictures.



With vibration correction

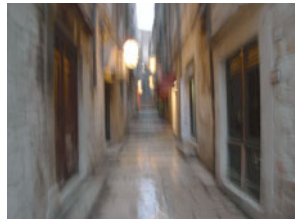

Without vibration correction

* Image shown is for demonstration purposes only. * Effects may not function under all situations.

1cm macro for ultra-precise close-ups

GX100 permits macro shots as close as 1cm away from the subject at the wide angle setting, and 4cm in the telephoto setting. This gives you the option of using the wide angle for emphasizing proximity, or the telephoto when you want to obscure images in the background. Other powerful features include a "Zoom Macro" setting to boost the size of macro images and auto focus targeting that can be moved without changing the picture composition.



f=37mm, 1/80sec, F4.2, ISO100, Full size photo; no trimming

Focus system lets you match up subject and shooting style

Use of multi AF with 17 separate auto focus points within the auto focus area prevents out-of-focus shots of two people, for example, even if you don't lock the focus. Center spot auto focusing is also available, as well as manual spot focusing, which is displayed by the monitor's focus bar. The easy-to-confirm focus indicator is a great convenience.

Three types of light metering adapt to virtually every situation

The multi metering mode splits the monitor into 256 segments and determines the ideal overall exposure. In addition, center weighted average metering and spot metering are included. This not only enables GX100 to be used in a variety of lighting situations, but also permits the user to give free range to his own "light-seeing eye."

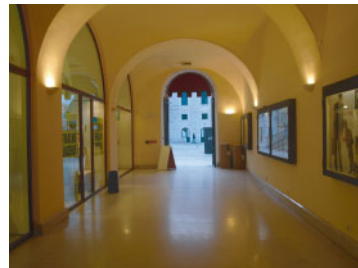

f=32mm, 1/80sec, F2.8, ISO100, EV-0.3, Full size photo; no trimming

Choice of versatile exposure modes

In addition to the Camera mode that entrusts settings to the camera, the GX100 boasts scene modes tailored to a variety of subjects and shooting situations. Three modes: "A" (aperture priority mode), "M" (manual exposure mode) and "P" (program shift mode) support your creative efforts. By according you full control over the subject's depth of field and emotions, the GX100 is an ideal camera for enjoying photographic expression.

Flexible shooting functions to match the subject

In addition to a 4:3 aspect ratio, GX100 can also be set to the same 3:2 ratio as a 35mm camera, as well as a 1:1 ratio. When used in combination with the LCD viewfinder's tilt function, you can enjoy the same "feel" as a medium-format camera. Picture settings include monochrome and sepia for touch of nostalgia.

Large 2.5-inch LCD monitor display permits wide-angle shooting

The 2.5-inch, 230,000 pixel LCD display can be clearly viewed horizontally or vertically from a 170-degree angle. Photos can be displayed as one frame, three frames or indexed contents, up to a maximum of 16 at a time. Display settings include marker displays, a histogram for visual display of light distribution, a grid guide (in the shooting mode), convenient for confirming parallel alignment and a highlight display (in the display mode) that darkens display over bright areas.

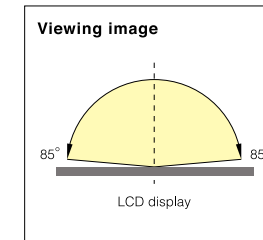

Grid guide display *Image is simulated

You'll never want to leave it at home



With use of 19mm wide conversion lens (DW-6), 1/130sec, F4.6, ISO100, Full size photo; no trimming

Customized settings fit to your personal style

A wealth of functions enables full versatility and ease of use. The ADJ. lever enables preprogramming of up to four frequently utilized functions, including focus, ISO sensitivity, metering system, continuous shooting and others, greatly facilitating making changes to settings. The function button also permits switching between manual and auto focus, AE lock and others, letting you make changes at a touch.

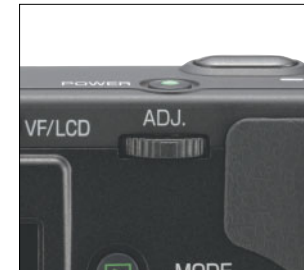

ADJ. lever (ADJ.)



Function button (Fn)

Frequently used "My Setting" options can be toggled at a touch

Two "My Setting" options allow you to preset the GX100 to match your most frequently used shooting styles and scenes. Once you've selected your preferences, just select the Mode setting and you'll be ready to shoot at a moment's notice.



Presettable functions:

- * Photo mode * Picture quality/size * Focus * Focus position during manual focus
- * Metering method * Continuous shooting * Exposure compensation * Photos with sound * Date entry * White balance * ISO sensitivity * Camera shake correction
- * Zoom position * Macro * Flash mode * Self-Timer * DISP mode * Step zoom * Digital zoom switch * Shooting icon enlargement

Scene modes give best exposure

A choice of eight still picture modes are provided: Portrait, Sports, Landscape, Nightscape, Skew Correction, Text, Zoom

Macro and High Sensitivity. Skew Correction makes objects shot at an angle appear as if they were shot from the front. Text brings black and white characters into sharp view, enabling the camera to serve as an electronic memo.

Versatile flash operation

The pop-up flash can be set to Flash-off, Auto, Red-eye Flash, Flash-on, Soft Flash, and Slow Synchro, to provide the ideal lighting for each type of scene. The GX100 also incorporates a hotshoe for connection of an external flash unit.

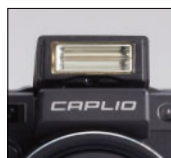

Flash Soft setting for close-up work

For macro or close-up wide angle shots, the flash intensity can be reduced. For macro photography or close-ups in the wide angle setting, this avoids overexposure of the subject, as well as preventing the background from appearing underexposed, affording extra control for more natural results.



f=24mm, 1/30sec, F9.1, ISO100, EV-0.7, Full size photo; no trimming

Slow Synchro mode ideal for night scene portraits

After the flash captures the subject at the ideal exposure level, the Slow Shutter continues exposure as-is, ensuring that even night scenes achieve the right balance. * A tripod should be used during slow shutter settings.

Movie mode

The GX100 shoots moving images of up to 640 x 480 pixels at 30 frames per second with sound. Image size from 640 x 480 pixels at 30 or 15 frames per second are selectable.

SDHC memory card for high-capacity recording of high-definition images

The GX100 can accommodate SDHC memory cards of up to 4GB capacity. This enables it to record a large volume of high-quality image data and thereby further extending its shooting capabilities.

Pleasing, high-durability body

The aluminum alloy body conveys an unmistakable sensation of quality and luxury that your hands can feel.

Functional, ergonomic body design

The natural lines and ergonomic controls make shooting with the GX100 smooth and effortless. The large, easy to handle grip section, covered with pliable resin material, provides a secure and comfortable grip for added stability during shooting. The control layout and positive click sensation of the buttons enhances its ease of use.

Approx. 340 shots per battery charge, plus AAA compatibility

The GX100 utilizes three power sources: rechargeable battery, AAA-type dry cells and an AC adapter *1. The large-capacity rechargeable battery permits approximately 340*2 shots. Alkaline batteries, available anywhere, can take up to 30 shots *2. Oxyride dry battery and Nickel hydrate rechargeable battery can also be used.



*1 Optional *2 Based on CIPA standards

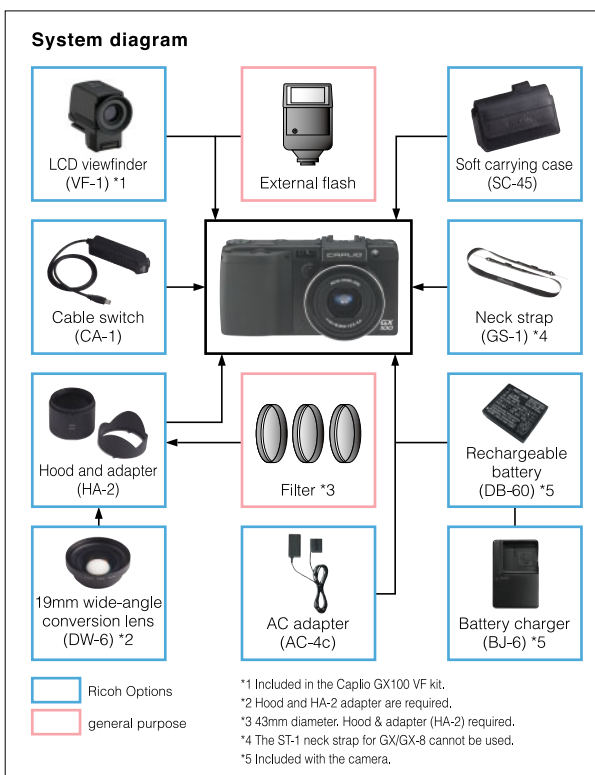



Caplio GX100 Optional Accessories

Product Name	Model Name
Rechargeable batteries	DB-60
Battery charger	BJ-6
AC adapter	AC-4c
LCD viewfinder *1	VF-1
Wide conversion lens *2	DW-6
Hood and adapter	HA-2
Soft case	SC-45
Neck strap *3	ST-2
Cable switch	CA-1

- *1 The VF-1 LCD viewfinder is included in "GX100 VF KIT".
*2 The HA-2 hood and adapter is required to use the wide conversion lens.
While the wide conversion lens is attached,
the internal flash can't be used because vignetting may occur.
*3 The ST-1 neck strap for the Caplio GX/GX8 cannot be used.

Caplio GX100 Major Specifications

Item	Description
CCD	Effective 10.01 million pixels (total 10.30 million pixels) / 1/1.75-inch primary-color CCD
Lens	Focal length: f=5.1 - 15.3 mm (35mm camera equivalent, 24 - 72mm) Aperture (F value): F 2.5 (Wide) - F4.4 (Tele) Lens construction: 11 elements in 7 groups
Vibration Correction Function	CCD shift method
Digital Zoom	Optical: 3X (35mm camera equivalent, 24 - 72mm) Digital: 4X (Maximum 12X when combined with optical) Step: 24mm, 28mm, 35mm, 50mm, 72mm
Shooting Distance	Approx. 30 cm - infinity from lens tip (Wide and Tele)
Macro Shooting Distance	Approx. 1 cm - infinity from lens tip (Wide), approx. 4 cm - infinity from lens tip (Tele) Approx. 1 cm - infinity from lens tip (Zoom macro mode)
Shutter Speed	<Still image> 180, 120, 60, 30, 15, 8, 4, 2, 1 - 1/2000 sec. <Movie> 1/30 - 1/2000 sec.
Pixels	<Still image> 3648 x 2736, 3648 x 2432, 2736 x 2736, 3264 x 2448, 2592 x 1944, 2048 x 1536, 1280 x 960, 640 x 480 3648 x 2736, 2048 x 1536 <Text> 640 x 480, 320 x 240 <Movie> 640 x 480, 320 x 240
Picture mode *1	F (Fine) / N (Normal) / RAW *2
ISO Sensitivity (Standard Output Sensitivity)	AUTO, AUTO-HI, ISO80 / ISO100 / ISO200 / ISO400 / ISO800 / ISO1600
Flash	Off, Auto, Red-eye reduction, On, Slow synchro, Soft Flash Flash range *3: Approx. 0.2 m - 5.0 m (Wide), 0.15 m - 3.0 m (Tele)
Focus	Multi AF / Spot AF / Manual focus / Snap / infinity (with AF Auxiliary Light)
Exposure Adjustment	TTL-CCD Metering method (AE lock possible for all meterings.): Multi light metering (256 segments), Center-weighted light metering, Spot metering
Exposure Compensation	Manual exposure Compensation +2.0EV - -2.0 (1/3EV Steps), Auto Bracket Function (-0.3EV, 0, +0.3EV / -0.5EV, 0, +0.5EV)
White Balance	Auto, Fixed (Outdoors, Cloudy, Incand., Fluores., Manual) / White Balance Bracket
Memory Type	SD Memory Card (32, 64, 128, 256, 512 MB, 1, 2 GB), SDHC Memory Card (4 GB), Multi Media Card, Internal Memory (26 MB)
Storage Capacity	<Still image> 3648 x 2736 (RAW:1 F:6 N:11), 3648 x 2432 (RAW:1 F:7 N:13) 2736 x 2736 (F:8), 3264 x 2448 (N:14), 2592 x 1944 (N:22), 2048 x 1536 (N:35), 1280 x 960 (N:62), 640 x 480 (N:276)
Storage Capacity (Time)	<Movie> 640 x 480 @30 frames/sec. (12 sec.), 640x480 @15 frames/sec. (24 sec.), 320 x 240 @30 frames/sec. (39 sec.), 320 x 240 @15 frames/sec*5. (1 min, 16 sec.), Internal 26 MB Memory)
Storage Data Capacity (Sizes are approximate)	<Still image> 3648 x 2736 (RAW:14.4 MB/Screen F:3.61 MB/Screen N:2.07 MB/Screen) 3648 x 2432 (RAW:12.8 MB/Screen F:3.21 MB/Screen N:1.85 MB/Screen) 2736 x 2736 (F:2.71 MB/Screen), 3264 x 2448 (N:1.67 MB/Screen) 2592 x 1944 (N:1.06 MB/Screen), 1280 x 960 (N:356 KB/Screen) 640 x 480 (N:83KB/Screen)
Recording Modes	Still image modes (Still Image / CONT / S-CONT / M-CONT), Program Shift / Aperture-Priority / Manual Exposure modes, Scene modes (Portrait / Sports / Landscape / Nightscape / Slew correction / Text / Zoom macro / High Sensitivity), Movie mode, My Setting1 & 2.
Recording Format	<Still image> JPEG (Exif Ver. 2.21)DCF6, RAW (DNG)*7 <Movie> AVI (Open DML Motion JPEG Format Compliant) <Sound> WAV (Exif Ver. 2.21 p.law)
LCD Monitor Display	2.5-inch Transparent Amorphous Silicon TFT LCD (approx. 230,000 pixels) Picture coverage 100%, viewing angle, 170 degrees (up-down, left-right)
Self-Timer	Operation time: approx. 10 sec. / approx. 2 sec.
Interval Timer	Shooting interval: 5 sec. - 3 hours (5 sec. steps)*8
PC Interface	USB2.0 High-Speed (mini - B cable), Choice of Ricoh original or Mass Storage driver*9
AV Interface	Audio Out, Video Out
Video Signal Format	NTSC / PAL
Dimensions	111.6 mm (W) x 58.0 mm (H) x 25.0 mm (D) (excluding projections parts)
Weight	Approx. 220 g (excluding batteries, Memory Card, strap), Accessories: approx. 30 g (battery, strap)
Battery	Rechargeable battery (DB-60) x 1, optional AC adaptor (AC-4c), AAA battery (alkaline / oxide / Nickel hydrate rechargeable battery) x 2
Shooting Capacity *10	Conforms to CIPA standard: using the DB-60, approx. 340 pictures (Using AAA alkaline batteries: approx. 30 pictures *11)
Operating Temperature	0°C - 40°C

- *1: Settable picture modes depend on image size.
*2: Simultaneous recording with same size Fine/Normal modes or Normal 640 mode JPEG image
*3: When the flash range is set for ISO AUTO or ISO 400
*4: Estimated number of still images it is possible to record
*5: Max. recording time of 184 min. 57sec. with 4GB SD Memory Card.
*6: Conforms to DCF, compatible with DPOF, DCF is the abbreviation for the JEITA Design Rules for Camera Files System.
(It does not guarantee perfect inter-camera compatibility.)
*7: The DNG file format is a raw image file format. It is a standard file format of Adobe Systems Inc.
*8: With flash OFF.
*9: Mass Storage driver is compatible with Windows Me/2000/XP/Vista, Mac OS9.0-9.2.2, and, Mac OSX10.1, 10.2-10.4.8
It is not compatible with Windows 98SE or Mac OS 8.6.
*10: Battery performance measured under conditions conforming to CIPA standards. These values are guidelines only.
The actual performance may vary according to user conditions and the battery manufacturer.
*11: With AAA alkaline batteries manufactured by Matsushita Battery Industrial Co., Ltd. (under the logo of Panasonic).

LCD viewfinder Major Specifications

Item	Description
External dimensions	19.6mm x 37mm x 39.4 mm (W x H x D), not including protruding areas.
Weight	Approx. 22 grams
Image display area	Ferro-electric polarization-type liquid crystal Equivalent to approx. 201,000 pixels
Lens	4 elements in 3 groups
Picture coverage	100%
Parallax compensation	-5 ~ +3 Dpt

Caplio GX100 Software

	Windows Vista	Windows XP	Windows 2000/Me/98SE
1. RICOH Gate La	○	○	○
2. Irodio Photo & Video Studio	○	○	○
3. USB Driver*	×	○	○
4. WIA Driver	×	○	×
5. Acrobat Reader	○	○	○
6. Desk Top Binder Lite	×	○	○

- * Ricoh original.
* For Support of Windows Vista, please look at our homepage (http://www.ricoh.com/r_dc/).
* Image editing software for Macintosh not included.

Caplio GX100 System requirement

	Windows
Operating system	Windows 98 Second Edition Windows 2000 Professional Windows Me Windows XP Home Edition / Professional Windows Vista
CPU	Pentium III 500MHz or faster, Pentium III 1 GHz or faster(Windows Vista)
Memory Space	Windows 98SE: 256MB or more Windows 2000: 256MB or more Windows Me: 256MB or more Windows XP: 256MB or more Windows Vista: 512MB or more
Hard Disk Space	Windows 98SE: 160MB or more (during installation) Windows 2000: 160MB or more (during installation) Windows Me: 160MB or more (during installation) Windows XP: 160MB or more (during installation) Windows Vista: 160MB or more (during installation)
Display Resolution	1024 x 768 pixels or greater
Display Colors	65,000 colors or greater
CD-ROM Drive	A CD-ROM drive compatible with the above-mentioned computer
USB Port	A USB port compatible with the above-mentioned computer

- * Only USB connection is available when connecting Caplio GX100 to a PC. Serial connection is unavailable.
* Valid for systems with preinstalled OS and USB port.
* Caplio GX100 is possible to use for Mac OS 9.0 to 9.2.2 and Mac OS X 10.1.2 to 10.4.8 by Mass Storage Connection.

Number of possible writings to SD memory card and elapsed times (based on recording mode)

Mode	Recording pixels	Picture mode	Built-in memory	64MB	128MB	256MB	512MB	1GB	2GB	4GB
Still	3648 x 2736	RAW	1 images	3 images	6 images	13 images	26 images	51 images	105 images	206 images
		Fine	6 images	15 images	31 images	63 images	127 images	244 images	495 images	973 images
		Normal	11 images	27 images	55 images	109 images	221 images	425 images	865 images	1699 images
	3648 x 2432	RAW	1 images	3 images	7 images	15 images	30 images	58 images	118 images	232 images
		Fine	7 images	17 images	35 images	70 images	142 images	274 images	558 images	1097 images
		Normal	13 images	30 images	61 images	122 images	247 images	476 images	960 images	1885 images
	2736 x 2736	Fine	8 images	20 images	42 images	83 images	169 images	325 images	660 images	1297 images
		Normal	14 images	33 images	68 images	136 images	275 images	530 images	1078 images	2117 images
	2592 x 1944	Normal	22 images	53 images	107 images	213 images	430 images	828 images	1661 images	3261 images
		Normal	35 images	83 images	169 images	338 images	682 images	1313 images	2671 images	5246 images
	1280 x 960	Normal	62 images	147 images	300 images	599 images	1208 images	2323 images	4726 images	9282 images
		Normal	276 images	644 images	1303 images	2598 images	5236 images	10071 images	20476 images	40206 images
Text	3648 x 2736		11 images	27 images	55 images	109 images	221 images	425 images	865 images	1699 images
	2048 x 1536		35 images	83 images	169 images	338 images	682 images	1313 images	2671 images	5246 images
Movie	640 x 480 (15frames/sec.)		00'24"	00'57"	1'56"	3'51"	7'46"	14'57"	30'24"	59'42"
	640 x 480 (30frames/sec.)		00'12"	00'28"	00'58"	1'56"	3'55"	7'31"	15'19"	30'4"
	320 x 240 (15frames/sec.)		1'16"	2'58"	5'59"	11'57"	24'5"	46'19"	94'11"	184'57"
	320 x 240 (30frames/sec.)		39"	1'31"	3'4"	6'7"	12'19"	23'42"	48'13"	94'40"

- * Number of recordable pictures and recordable time may vary depending on the manufacturer of an SD memory card and shooting conditions.
* Average number of images and time.

RICOH

RICOH COMPANY, LTD.

3-2-3, Shin-yokohama
Kohoku-ku, Yokohama-shi 222-8530, Japan
Phone: 045-477-1738 Fax: 045-477-1797 http://www.ricoh.com/r_dc

RICOH INTERNATIONAL B.V.

Oberrather Straße 6, D-40472
Düsseldorf, Germany
Phone: 0211-6546-0 Fax: 0211-6546-308 <http://www.ricohpmmc.com>

RICOH UK LTD. (PMMC UK)

Ricoh House, 1 Plane Tree Crescent, Feltham,
Middlesex, TW13 7HG, England
Phone: 0208-261-4000 Fax: 0208-261-4288

RICOH FRANCE S.A.S. (PMMC FRANCE)

383, Avenue du Général de Gaulle – BP 307-931-13
Clamart Cédex, France
Phone: 01-4094-3267 Fax: 01-4094-3276

RICOH ESPANA, S.A. (PMMC SPAIN)

Av. Litoral Mar, 12-14, 08005
Barcelona, Spain
Phone: 093-295-7600 Fax: 093-295-7605

RICOH ITALIA S.p.A. (PMMC ITALY)

via Ponchielli, 3
20063 Cernusco S/N Milano, Italy
Phone: +39-02-92361217 Fax: +39-02-92361244

RICOH ASIA PACIFIC OPERATIONS LIMITED

Personal Multimedia Products Center
21/F, One Kowloon, 1 Wang Yuen Street, Kowloon Bay, Hong Kong
Phone: 2862-2888 Fax: 2566-3647/2866-1120

● Caplio is a trademark of Ricoh Co., Ltd. ● Microsoft, Windows, Windows Vista, and DirectX are either registered trademarks or trademarks of Microsoft Corporation in the United States and/or other countries. ● Apple, Macintosh and Mac OS are registered trademarks or trademarks of Apple Inc. in the U.S. and / or other countries. ● The SD logo is a trademark. ● OXYRIDE is a trademark of Matsushita Electric Industrial Co., Ltd.
● Compatible with EPSON PRINT Image Matching III. ● All other trademarks mentioned herein are the property of their respective owners.



For more information, visit:

<http://www.ricohpmmc.com>